

530PL Optional latches with plastic lock

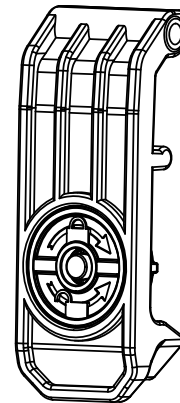

530ML Optional latches with plastic lock

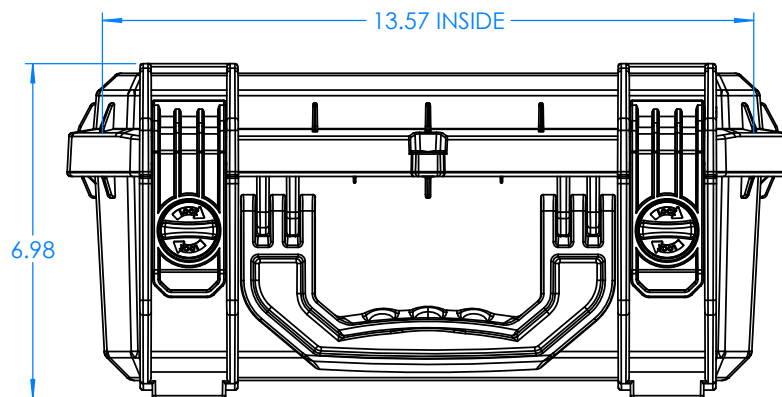
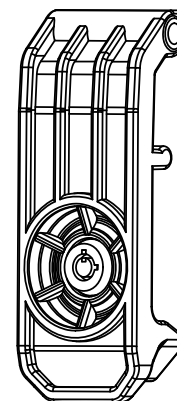

NOTES:

- 1) Max. usable inside dimensions are: 13.5" X 9.9" X 6" (5.9" to top of bosses)
- 2) With Metal Lock Latches p/n 530ML and Plastic Lock Latches p/n 530PL are optional.
- 3) Dimensions to bottom of panel flange.
- 4) Bosses on bottom use a 1/4" self tapping screw. Bosses on the top use a #10 self tapping screw.

3/6/18